

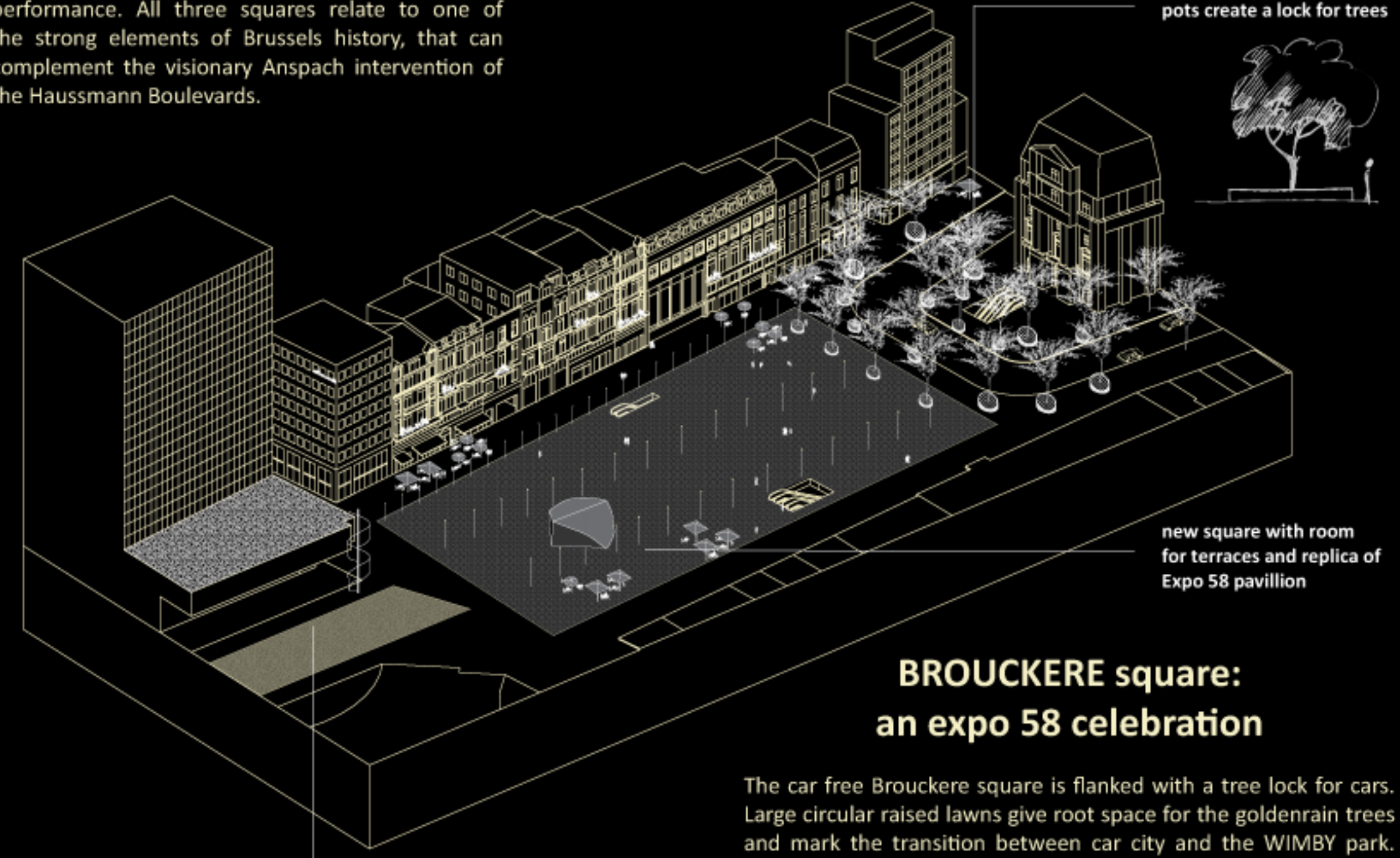

Each of the three public squares along the Wimby park will be designed as strong recognizable and fairly empty spaces. They invite the park visitors and residents to stage their own uses on the square, from concerts to pick nick, from manifestation to performance. All three squares relate to one of the strong elements of Brussels history, that can complement the visionary Anspach intervention of the Haussmann Boulevards.



goldenrain trees in large pots create a lock for trees



BROUCKERE square: an expo 58 celebration

The car free Brouckere square is flanked with a tree lock for cars. Large circular raised lawns give root space for the goldenrain trees and mark the transition between car city and the WIMBY park. The open space behind it features a replica of the former expo58 pavilion, celebrating one of the highlights of Brussels, the world expo in 1958. The rest of the square serves as an incubator for social manifestations, events and large terraces. The Metropole terrace is given some breathing space and is not longer separated from the square by a sea of parked cars and taxi's.

small topography changes and various vegetation height make up the green carpet

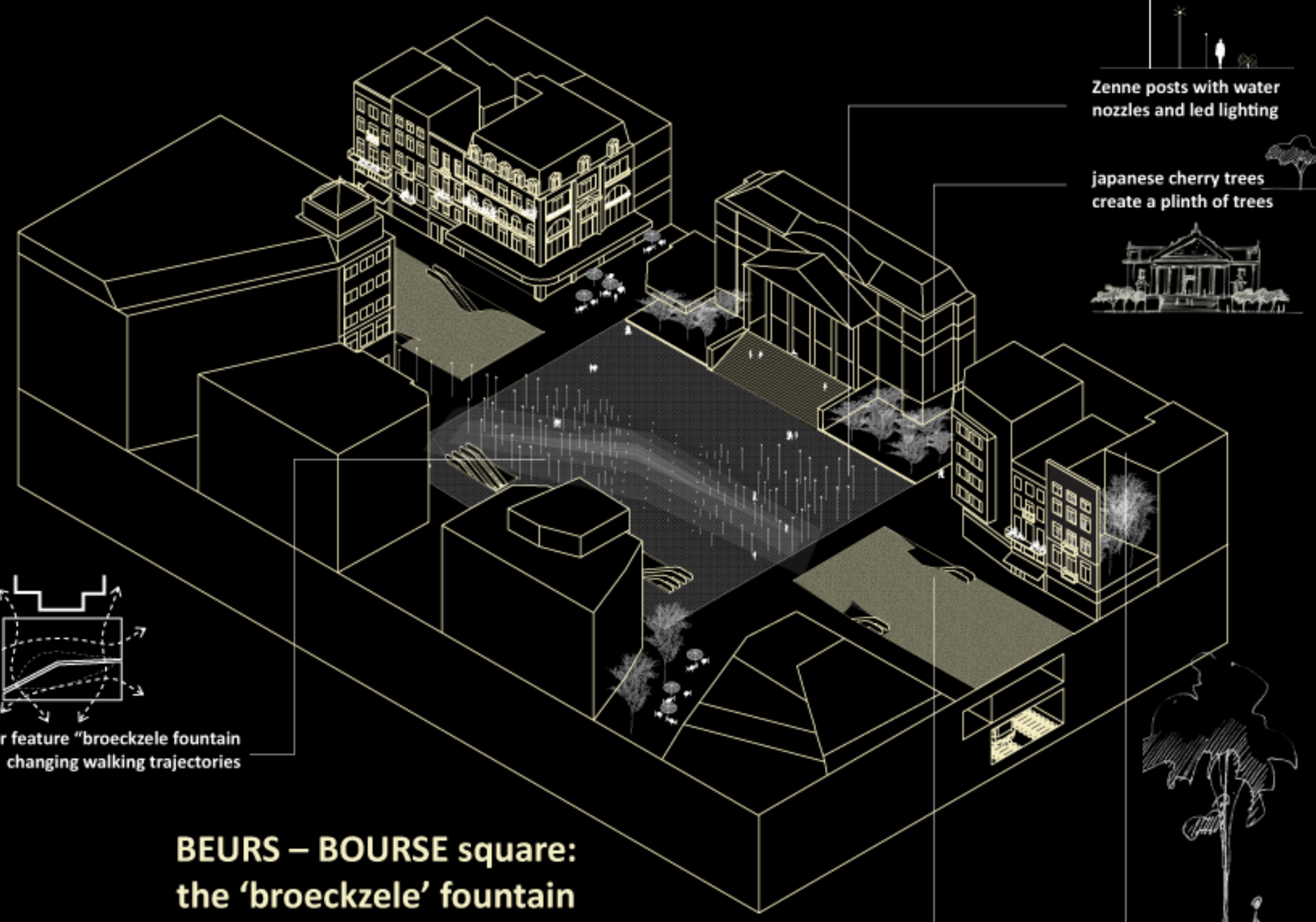

BEURS – BOURSE square: the 'broeckzele' fountain

The eclectic architecture of the Stock Exchange Building is complemented with a green pedestal. A densely vegetated strip is wrapped around the building, extending the building's base into the public space. The new pedestal consists of cherry trees with a grass meadow underneath, inviting people to dwell under the foliage and blossoms, much closer to the building than its more formal entrance and stairs.

The square in front of the Beurs/Bourse is the one spot where the symbolic representation of the river Zenne becomes tangible in a water feature. A subtle tilt of the square's surface aligned with the old trajectory of the river Zenne, supports a field of water nozzles. They can be programed as a playful water fountain but could just as well follow a more artistic interpretation of the actual underground water volume passing through the Zenne tubes. Filling up and emptying the crease in the surface as if breathing the spirit of the former Zenne. The symbolic meaning of the water feature that might be hard to cross at times, refers to the Broeck- Zele etymology, a space to cross the water, right at the heart of the WIMBY park.

Zenne posts with water nozzles and led lighting



japanese cherry trees create a plinth of trees

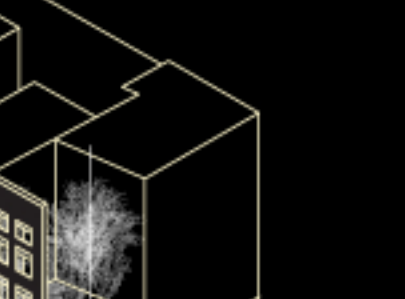

water feature "broeckzele fountain" changing walking trajectories

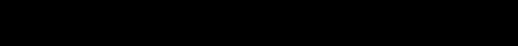

pocketparks with tall trees and climbing plants

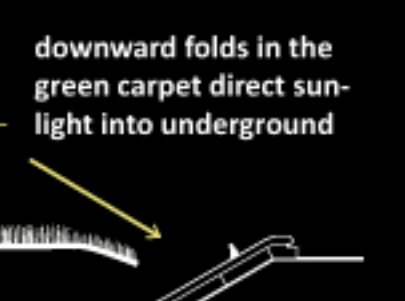

downward folds in the green carpet direct sun-light into underground

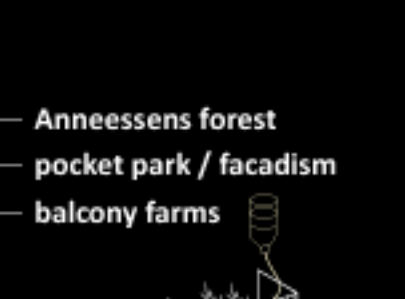

FONTAINAS square: the Zenne forest

At the other end of Wimby park a third theme of Brussels is introduced. The Zoniën Forest is recreated stretching from Anneessenspark towards the Fontainas Square. Much less formal as the Brouckere square, this urban forest is catering towards local residents, which is the main occupant of the southern part of WIMBY park. He mixture of trees and Zenne posts create a specific light quality both during day time and night time. The forest also serves as a clear demarcation of the start of the car free zone, a border that is perceived from a sufficient distance.

Anneessens forest pocket park / facadism balcony farms

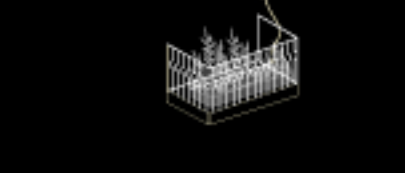

honey locust cafe terraces
zenne posts with water nozzles and led lighting

